



 **Where Ideas Meet Industry**

LT Series – Hermetically Sealed Miniature Timing Relays



LT miniature thermal time delay relays are a unique design incorporating small size with the ability to meet the most stringent shock and vibration requirements. The LT Series are widely used for environmentally demanding industrial and commercial applications where operational requirements and size are a major criteria for selection.

Benefits include . . .

Small size • Hermetically sealed, factory set • Low profile • Shock and vibration resistant • Will meet MIL-R-19648 requirements

Specifications

| | |
|--------------------------|--|
| Delay Range | 2 - 75 Seconds |
| Operating Tolerance | ±15% at rated voltage |
| Vibration | 10g/500 cps |
| Shock | 50g-11ms |
| Operating Temperature | -65°C to +85°C (-85°F to +185°F) |
| Standard Heater Voltages | 28 and 115 VAC/VDC |
| Contacts | SPST - N.O. and N.C. |
| Contact Ratings | Non-Inductive: 2 amps to 250 VAC 1 amp to 32 VDC Inductive: 25VA to 250 VAC** 1/8 amp to 32 VDC |
| Power Requirement | 4 watts |
| Connections | Hook-pin, 7 point |
| Finish | Corrosion-resistant plating |

**1 amp maximum below 32 V

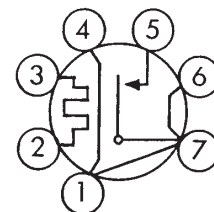
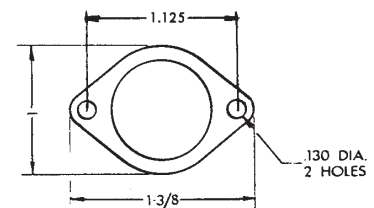
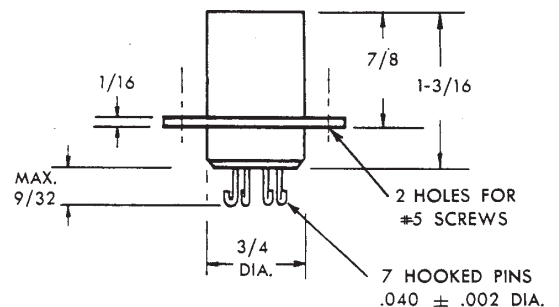

WIRING CONNECTIONS

Standard Models

Normally Open Contacts

| Delay Time (Seconds) | RATED HEATER VOLTAGE | | | |
|----------------------|----------------------|---------|-------------|---------|
| | 28 VAC/VDC | | 115 VAC/VDC | |
| | NO | NC | NO | NC |
| 2 | LT-2101 | LT-2102 | LT-3101 | LT-3102 |
| 5 | LT-2201 | LT-2202 | LT-3201 | LT-3202 |
| 7 | LT-2421 | LT-2422 | LT-3409 | LT-3410 |
| 10 | LT-2401 | LT-2402 | LT-3401 | LT-3402 |
| 15 | LT-2501 | LT-2502 | LT-3501 | LT-3502 |
| 30 | LT-2601 | LT-2602 | LT-3601 | LT-3602 |
| 50 | LY-2711 | LT-2712 | LT-3711 | LT-3712 |
| 60 | LT-2801 | LT-2802 | LT-3801 | LT-3802 |
| 75 | LT-2811 | LT-2812 | LT-3811 | LT-3812 |

Note: Custom voltages and timings available upon request.

World leaders



Radiodetection is a proud member of the SPX group of companies, which provide technical products and service solutions worldwide.

Radiodetection and its associated companies specialize in the design and manufacture of products for the location and maintenance of underground pipes and cables. Our aim is to be viewed as the supplier of choice of 'high performance' quality equipment using advanced product technologies. We are also committed to both design innovation and customer support.

Technical support



Radiodetection equipment users have easy access to technical support. A call to your regional representative, or the Radiodetection head office, will put you in contact with our team of field-experienced technical experts.

Servicing and repair



Radiodetection has a team of factory-trained service technicians and dedicated service facilities. Turnaround is fast, and costs are very competitive.

Training



Product training for your operators and training personnel is available on your site, or at Radiodetection's headquarters. Training is with qualified instructors and each trainee receives a certificate to confirm they have received the training.

America

Radiodetection

154 Portland Road
Bridgton, ME 04009, USA
Tel: +1 (207) 647 9495
Toll Free: +1 (877) 247 3797
Fax: +1 (207) 647 9496
Email: rd.sales.us@spx.com
Web: www.radiodetection.com

Pearpoint

72055 Corporate Way
Thousand Palms CA 92276, USA
Tel: +1 800 688 8094
Tel: +1 760 343 7350
Fax: +1 760 343 7351
Email: pearpoint.sales.us@spx.com
Web: www.radiodetection.com

Radiodetection (Canada)

344 Edgeley Boulevard, Unit 34
Concord, Ontario L4K 4B7, Canada
Tel: +1 (905) 660 9995
Toll Free: +1 (800) 665 7953
Fax: +1 (905) 660 9579
Email: rd.sales.ca@spx.com
Web: www.radiodetection.com

Europe

Radiodetection Ltd (UK)

Western Drive
Bristol BS14 0AF, UK
Tel: +44 (0) 117 976 7776
Fax: +44 (0) 117 976 7775
Email: rd.sales.uk@spx.com
Web: www.radiodetection.com

Radiodetection (France)

13 Grande Rue, 76220
Neuf Marché, France
Tel: +33 (0) 232 8993 60
Fax: +33 (0) 235 9095 58
Email: rd.sales.fr@spx.com
Web: <http://fr.radiodetection.com>

Radiodetection (Benelux)

Industriestraat 11
7041 GD 's-Heerenberg, Netherlands
Tel: +31 (0) 314 66 47 00
Fax: +31 (0) 314 66 41 30
Email: rd.sales.nl@spx.com
Web: <http://nl.radiodetection.com>

Radiodetection (Germany)

Groendahlscher Weg 118
46446 Emmerich am Rhein, Germany
Tel: +49 (0) 28 51 92 37 20
Fax: +49 (0) 28 51 92 37 520
Email: rd.sales.de@spx.com
Web: <http://de.radiodetection.com>

Asia-Pacific

Radiodetection (Asia-Pacific)

Room 708, CC Wu Building
302-308 Hennessy Road, Wan Chai
Hong Kong SAR, China
Tel: +852 2110 8160
Fax: +852 2110 9681
Email: rd.sales.cn@spx.com
Web: www.radiodetection.com

Radiodetection (China)

Hongfu Mansion, Room 61622
Zheng Ge Zhuang, Bei Qi Jia Town
Chang Ping District
Beijing 102209, China
Tel: +86 (0) 10 8975 5540
Fax: +86 (0) 10 8975 5640
Email: rd.service.cn@spx.com
Web: <http://cn.radiodetection.com>

Radiodetection (Australia)

Unit 14, 5-7 Prosperity Parade
Warriewood NSW 2102, Australia
Tel: +61 (0) 2 9979 8555
Fax: +61 (0) 2 9979 7733
Email: rd.sales.au@spx.com
Web: www.radiodetection.com

To see the full range of products and services provided by Radiodetection visit:

www.radiodetection.com

Radiodetection products are under continuous development and are subject to change, we reserve the right to alter or amend any published specification without notice.

Copyright 2008 Radiodetection Ltd. - SPX Corporation. All rights reserved. Radiodetection Ltd. is a subsidiary of SPX Corporation.



Radiodetection
AN SPX COMPANY



Global Headquarters
13515 Ballantyne Corporate Place
Charlotte, North Carolina 28277
United States

Where Ideas Meet Industry

Where Ideas Meet Industry

www.spx.com